



# **Cross Lutheran School**

## **School Growth Campaign 2008-2009**



**Preparing for  
Tomorrow  
with a Christ-Centered  
Education Today!**

**2171 E. Common St.  
New Braunfels, TX 78130  
Phone: 830-625-3969  
Website: [www.crosslcmsschool.org](http://www.crosslcmsschool.org)**

**Kevin Dierks, Principal**

To Pledge by Phone Call: 830-625-3969



Friends of Cross Lutheran School,

Cross Lutheran is an **unbelievably wonderful** place for learning. Christian education at Cross Lutheran is an impressive presentation and opportunity. What an overwhelming, yet unbelievably fulfilling job description we have as Christian educators. Thank you to your family for joining us for the challenges and opportunities that abound.

The intent of this packet is to educate and inform you about the opportunities afforded to our school. As God wills it, a modular will be in place to be to begin the 2009-2010 school year. This modular building will be the home for 5th through 8th grades with a dedicated science/computer lab and a dedicated art/language lab. I encourage you to share the pamphlet with family, friends, and businesses that you believe would like to hear about and/or support the plans at Cross Lutheran School. This \$300,000 project could be viewed as yet another **unbelievable** challenge. Cross Lutheran's 2008-2009 School Year theme, based on John 14:12, is one that we can bank on, **His Passion in Action**, "Will do **Even GREATER Things**."

I look forward to the year(s) ahead as we watch God's guiding hand unfold His blessings and opportunities, in His time.

God bless you,

Kevin Dierks  
Principal  
I Thessalonians 5:16-19



## Funding required for Portable Classrooms

<b>Building cost</b>	<b>\$230,000</b>
<b>Landing &amp; ramp</b>	<b>\$7,000</b>
<b>Pad setup cost</b>	<b>\$6,000</b>
<b>Utilities install cost</b>	<b>\$22,000</b>
<b>Permit costs</b>	<b>\$2,000</b>
<b>TOTAL PROJECT</b>	<b>\$267,000</b>

The proposed use of this building will be to house 5th through 8th grades with a dedicated Science/Computer Lab and a dedicated Art/Language Room. Our teachers and students are excited to have this building to accommodate our growth. **All gifts will make a difference!**

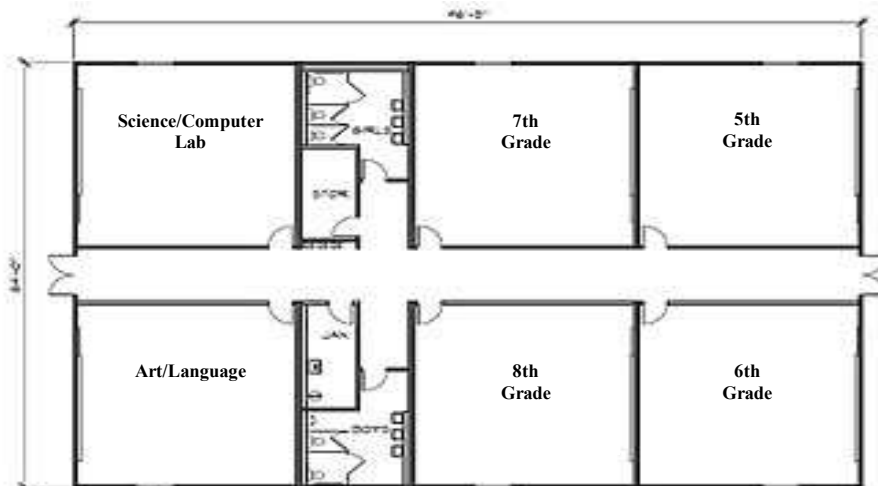

**To Pledge by Phone Call: 830-625-3969**



**LCD Projector**

A portable LCD projector with sufficient brightness for most classrooms and conference rooms, the projector is designed to be reliable and easy to maintain. Projector comes with remote control, batteries, power cord, RGB cable, operator's manual, and soft carry case.

**Price: \$700 each      TOTAL:**  
**Quantity needed: 2                      \$1,400**



**Overhead Projector Screens**

Durable matte white projection screen. Designed for easy wall mount and stable ceiling suspension.

**Price: \$130 each      TOTAL:**  
**Qty needed: 4 now (2 later)      \$780**

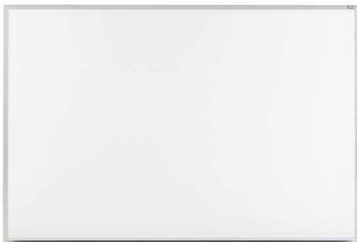

**Magnetic Markerboard**

Magnetic Markerboard is a great choice for any busy classroom. The porcelain-on-steel dry erase surface is easy to clean off and resists scratching and ghosting. The aluminum frame and 1/2" thick fiberboard backing makes it strong and sturdy. Attach magnets without marring the surface.

**Price: \$259 each      TOTAL:**  
**Quantity needed: 12                      \$3,108**  
**Qty needed: 12                      \$3,000**



**Bulletin Boards**

A tan self-sealing natural corkboard laminated to a rigid backing. Comes with hanging hardware.

**Price: \$174 each      TOTAL:**  
**Quantity needed: 14                      \$2,436**

To Pledge by Phone Call: 830-625-3969



### 2-Tier Lockers

Standard-style lockers include vandal-resistant recessed handle with powder-coat paint finish. Ventilation holes allow for easy identification of stinky shoes or old lunches.

**Price: \$461 set      TOTAL:**

**Quantity needed: 4 sets      \$1,844**



### Teacher Storage Cabinet

When it comes to selecting school furniture, flexibility is a necessity. Contemporary-design toe kick is both attractive and hides heavy-duty swivel casters, giving these units a built-in look. Rugged construction stands up to years of student use.

**Price: \$1,400 each      TOTAL:**

**Quantity needed: 4      \$5,600**



### Teacher Desk

This steel desk has two locking file drawers in addition to two box drawer so teachers have plenty of room to store files and papers without taking up valuable classroom space

**Price: \$350 each      TOTAL:**

**Quantity needed: 4      \$1,400**



### Teacher Multi-Use Chair

A great comfortable, adjustable chair for teachers only that will only fall over when a student is spinning more than 15 mph.

**Price: \$94 each      TOTAL:**

**Quantity needed: 4      \$376**

**To Pledge by Phone Call: 830-625-3969**



**Rubbermaid Rim Caddy**

Brute Rim Caddy has specially contoured slots for spray bottles, brooms and other cleaning tools and supplies.

**Price: \$70**                      **TOTAL:**  
**Quantity needed: 1**                      **\$70**



**Mop Bucket/Wringer Combo**

1-piece design: integrated bucket and wringer. Holes in both wringing plates force more water from mop in less time. Reverse-wring mechanism for more comfortable use.

**Price: \$70 each**                      **TOTAL:**  
**Quantity needed: 1**                      **\$70**



**Vacuum Cleaner**

This commercial grade vacuum cleaner has 7 amps and a furniture guard. It is so powerful that you must have a license to operate it! ( Not really! )

**Price: \$400 each**                      **TOTAL:**  
**Quantity needed: 1**                      **\$400**



**Classroom Cabinetry and Countertops**

Cabinetry with countertops are needed for the classrooms.

**Price: \$2000 per room**  
**TOTAL:**  
**Quantity needed: 4**                      **\$8000**

**To Pledge by Phone Call: 830-625-3969**



**4 Student Science Workstation**

*Unique design allows instructor to see students, fixtures and storage areas from the front of the room. Constructed of select oak and oak veneers. The surface is impervious to normal laboratory chemicals, heat and moisture.*

**Price: \$2,684 each    TOTAL:**

**Quantity needed: 6                    \$16,104**



**Microscope with Digital Pupilcam**

A microscope with the ultra high-resolution 1.3 megapixel camera with digital CMOS technology. Complete with Applied Vision™ Software for Windows® to record images or movies, time-lapse sequences, and capture still images.

**Price: \$340 each    TOTAL:**

**Quantity needed: 1                    \$340**



**Lab Stools**

Tough enough to stand up to daily use, the stool features a sturdy steel tubing base and a fiberboard seat that will not chip or crack.

**Price: \$40 each    TOTAL:**

**Quantity needed: 25                    \$1,000**



**Emergency Shower & Eyewash**

Space-saving unit includes overhead drench shower and independently operated eye/face wash. Includes universal identification sign and inspection tag.

**Price: \$800 each    TOTAL:**

**Quantity needed: 1                    \$800**

**To Pledge by Phone Call: 830-625-3969**



**Student Desk**

This school desk gives students a durable place to work. The roomy book box offers plenty of space. The fiberboard work surface is protected by a scratch-resistant light oak laminate

**Price: \$40      TOTAL:**

**Quantity needed: 25                      \$1,000**



**Student Chair**

A sturdy copolymer seat and back with heavy-duty steel legs. Recommend for grades 6 and up.

**Price: \$40 each      TOTAL:**

**Quantity needed: 25                      \$1,000**



**Plastic Folding Table**

The folding table is impact resistant, lightweight, and a cinch to set up, making it a good choice for schools. The waterproof top resists stain and scratches, so it looks good after multiple uses.

**Price: \$150 each      TOTAL:**

**Quantity needed: 6                      \$900**



**Art Drying Rack**

Large shelves will hold paper measuring up to 37" x 24". System has a total of 12 shelves; up to two racks can be stacked together to double your paper storage.

**Price: \$432 each      TOTAL:**

**Quantity needed: 1                      \$432**

To Pledge by Phone Call: 830-625-3969

**Copier**



A copy machine will allow teachers/students to make necessary copies for instruction and homework.

Price: \$500                      TOTAL:  
 Quantity needed: 1                      **\$500**

**Portable Computer/Laptop Cart**



The Portable Laptop Cart stores and charges up to 30 notebook computers in individual compartments and provides room on the top shelf for a work surface or for use with printers or wireless devices.

Price: \$1800 each                      TOTAL:  
 Quantity needed: 1                      **\$1800**

## Additional Science Equipment

Item Name	Per Unit	Qty.	Total
Bunsen Burners	\$ 18.95	10	\$ 189.50
Gas Lighter	\$ 2.50	10	\$ 25.00
Petri Dish (Pkg of 12)	\$ 37.55	10	\$ 375.50
Agar Media Set	\$ 30.30	2	\$ 60.60
Glass Slides/Coverslips (box of 72)	\$ 16.75	2	\$ 33.50
Safety Goggles (pack of 10)	\$ 48.75	1	\$ 48.75
Large Display Timer	\$ 32.00	1	\$ 32.00
Student Lab Apron	\$ 2.75	60	\$ 165.00
Litmus Paper (1200 strips)	\$ 9.50	1	\$ 9.50
<b>TOTAL</b>			<b>\$ 939.35</b>

